



Lord Estates

Established 1978

MARBLE ARCH, W2 2QR



£360 Per Week / £1,560 Per Month

A lovely and bright studio flat on the seventh floor in this purpose built block. Presented in good decorative order, the property comprises welcoming well-proportioned studio room, separate kitchen, and bathroom. The property is situated in Edgware Road and is conveniently positioned close to the amenities along Edgware Road and Marble Arch. The property is offered furnished. Council Tax Band: C Local Authority: Westminster City Deposit: £1750



PARK WEST

APPROXIMATE GROSS INTERNAL FLOOR AREA 297 SQ.FT (27.6 SQ.M)

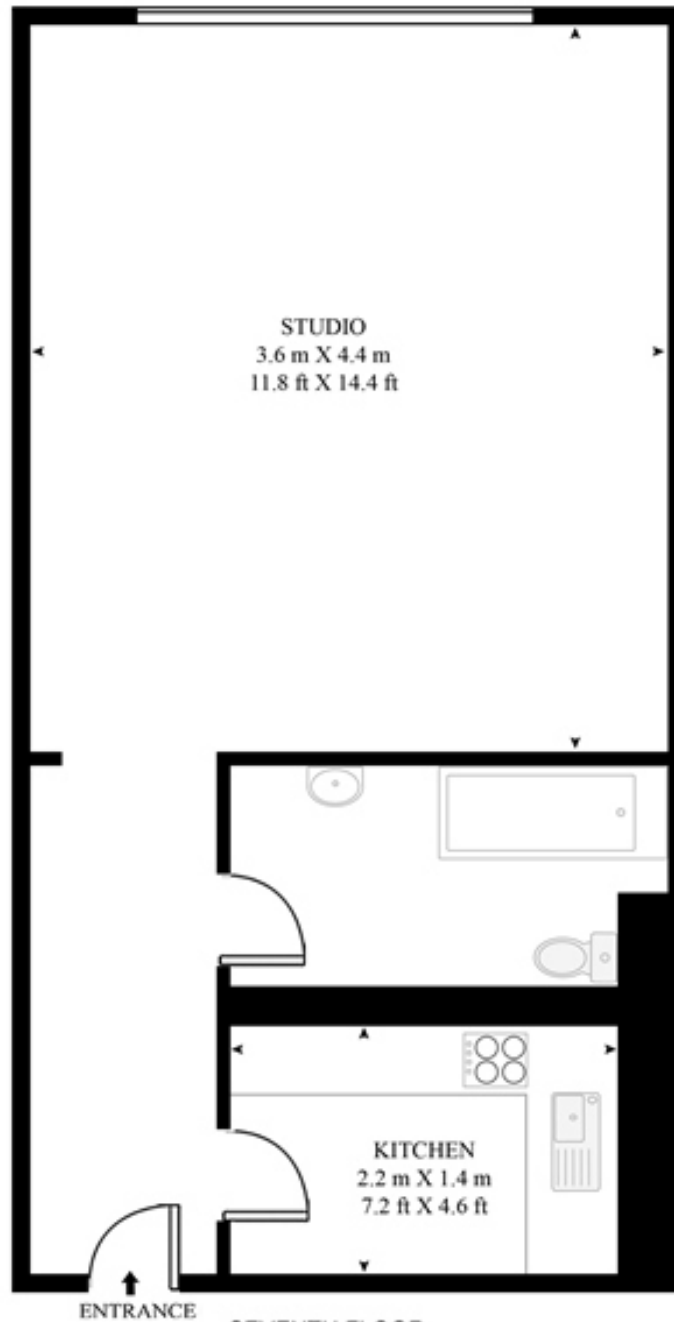

HDVA

This floor plan has been defined by the RICS Code of Measurement. This floor plan and all others are for approximate representative purposes only and upon usage is agreed to as such by the client.

WWW: hdvirtualart.com | TEL: 0207 923 7300 | EMAIL: info@hdvirtualart.com

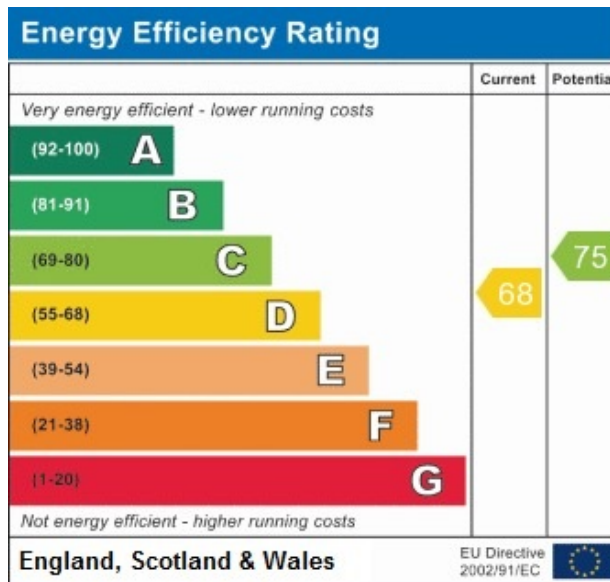

Terms and conditions

Property Misdescriptions Act 1991

The Agent has not tested any apparatus, equipment, fixture, fittings or services, and so does not verify they are in working order, fit for their purpose, or within ownership of the sellers, therefore the buyer must assume the information given is incorrect. Neither has the Agent checked the legal documentation to verify legal status of the property or the validity of any guarantee. A buyer must assume the information is incorrect, until it has been verified by their own solicitors.

The measurements supplied are for general guidance, and as such must be considered as incorrect. A buyer is advised to re-check the measurements themselves before committing themselves to any expense. Nothing concerning the type of construction or the condition of the structure is to be implied from the photograph of the property. The sales particulars may change in the course of time, and any interested party is advised to make final inspection of the property prior to exchange of contracts.

Misrepresentation Act 1967

These details are prepared as a general guide only, and should not be relied upon as a basis to enter into a legal contract, or to commit expenditure. An interested party should consult their own surveyor, solicitor or other professionals before committing themselves to any expenditure or other legal commitments.

If any interested party wishes to rely upon any information from the agent, then a request should be made and specific written confirmation can be provided. The Agent will not be responsible for any verbal statement made by any member of staff, as only a specific written confirmation should be relied upon. The Agent will not be responsible for any loss other than when specific written confirmation has been requested.