



Lord Estates

Established 1978

MONTAGU STREET, W1H 7EZ



£507 Per Week / £2,200 Per Month

A delightful light and airy 1 bedroom apartment offering newly refurbished and well arranged living space. The property is situated a few minutes walk to Marble Arch, both Portman Village and Marylebone Village with a great choice of boutiques and cafes. Open spaces of Hyde Park is also within close reach. Gross Internal Area: 405 Sq ft / 37.7 Sq M approx. Council Tax Band: D Local Authority: Westminster City
Deposit: £2,140.00 EPC: C



MONTAGU STREET

Approximate Gross Internal Area = 38.8 sq m / 418 sq ft

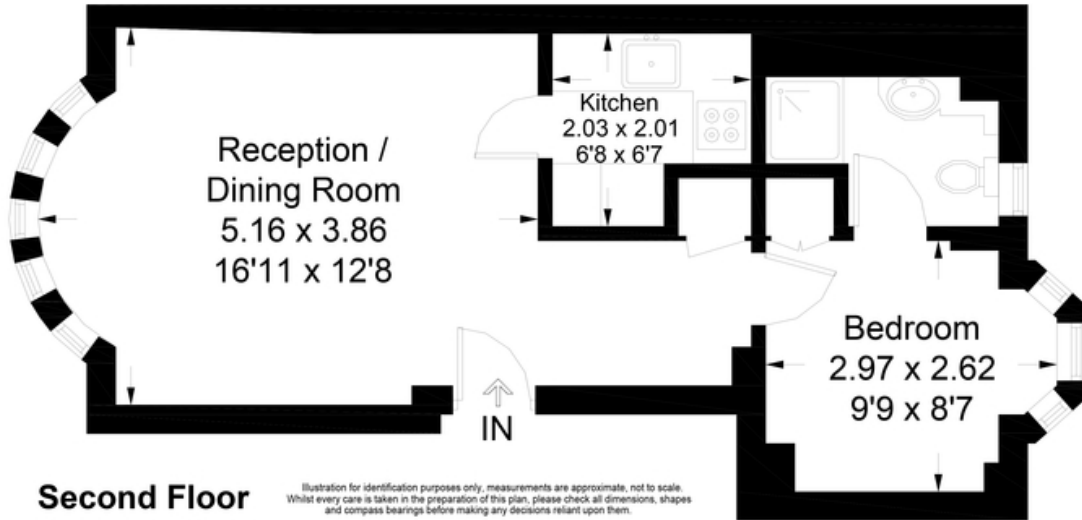

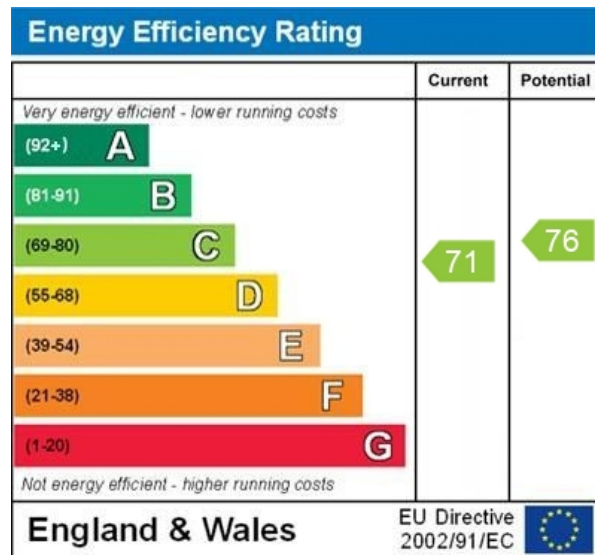

WWW.EPC4U.COM

Terms and conditions

Property Misdescriptions Act 1991

The Agent has not tested any apparatus, equipment, fixture, fittings or services, and so does not verify they are in working order, fit for their purpose, or within ownership of the sellers, therefore the buyer must assume the information given is incorrect. Neither has the Agent checked the legal documentation to verify legal status of the property or the validity of any guarantee. A buyer must assume the information is incorrect, until it has been verified by their own solicitors.

The measurements supplied are for general guidance, and as such must be considered as incorrect. A buyer is advised to re-check the measurements themselves before committing themselves to any expense. Nothing concerning the type of construction or the condition of the structure is to be implied from the photograph of the property. The sales particulars may change in the course of time, and any interested party is advised to make final inspection of the property prior to exchange of contracts.

Misrepresentation Act 1967

These details are prepared as a general guide only, and should not be relied upon as a basis to enter into a legal contract, or to commit expenditure. An interested party should consult their own surveyor, solicitor or other professionals before committing themselves to any expenditure or other legal commitments.

If any interested party wishes to rely upon any information from the agent, then a request should be made and specific written confirmation can be provided. The Agent will not be responsible for any verbal statement made by any member of staff, as only a specific written confirmation should be relied upon. The Agent will not be responsible for any loss other than when specific written confirmation has been requested.